

CONSTRUCTION SIGN AND BARRICADE LOCATION DETAILS

FHWA REGION	STATE	FED. AID PROJ. NO.	SHEET NO.
8	N.D.		51

D-754-718

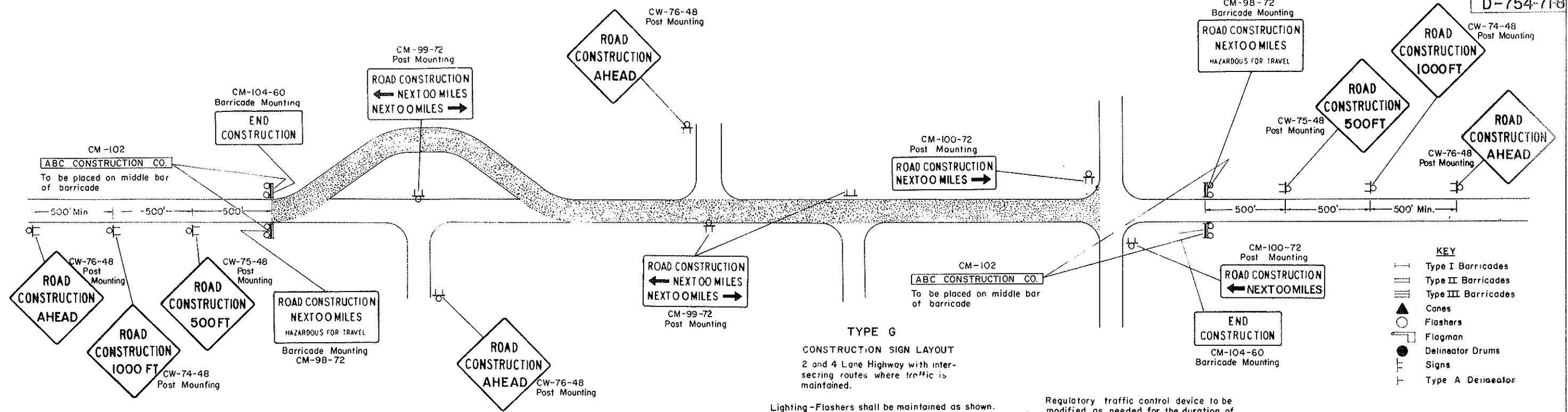

TYPE G
CONSTRUCTION SIGN LAYOUT
2 and 4 Lane Highway with intersecting routes where traffic is maintained.

Lighting - Flashers shall be maintained as shown. If danger exists at night or work area is closed to the traffic lane, the edge of the traffic lane on the work area side shall be illuminated by flashers or reflectorized delineators spaced at 100ft. centers. The flashers shall be placed above the barricade bar and above the warning signs.

Regulatory traffic control device to be modified as needed for the duration of construction.

FLAGS: All advance warning signs shall have two orange warning flags 24" square mounted perpendicular to the edges of the diamond sign and at such a distance above the edges so that when flag is hung limp it will not touch the sign.

Note: Sign No CM-101-72 shall be used on all projects where traffic is maintained. All intermediate signs shall be moved as work progresses and shall be removed when hazard ceases to exist. Two lighted flashers shall be maintained in front of all intermediate signs if hazard remains at night.

Where advance warning sign placed as shown interferes with permanent signs, The warning sign location shall be determined by the Engineer for best results. Messages shall be varied as required.

Mounting - Barricade shown to be placed on roadway shall be on a movable Assembly. Sign to be mounted on barricades shall be mounted with the sign bottom on the top of the top barricade bar. Intermediate Sign shall be on a movable assembly. Sign show to be placed on roadway shall be placed on movable assemblies.

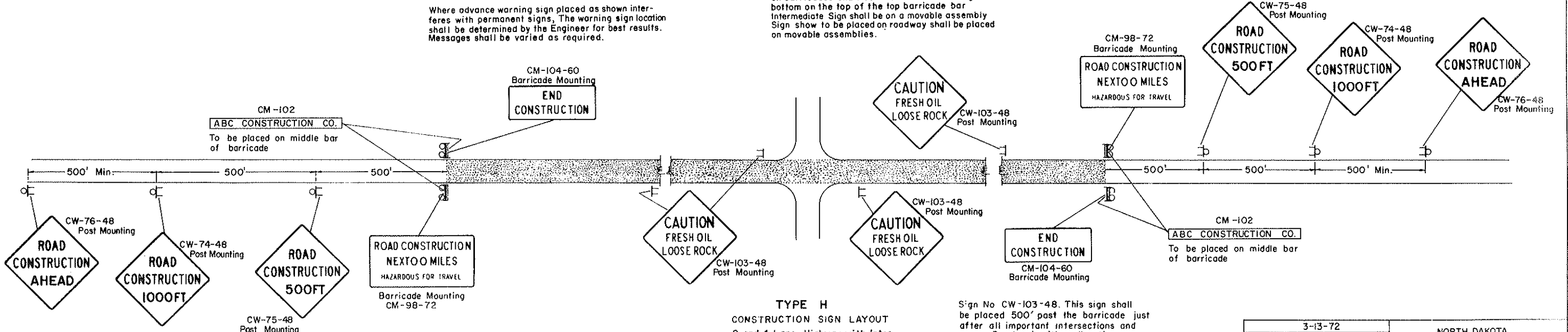

TYPE H
CONSTRUCTION SIGN LAYOUT
2 and 4 Lane Highway with intersecting routes where traffic is maintained over seal project.

Sign No CW-103-48. This sign shall be placed 500' post the barricade just after all important intersections and every 5 miles in either direction.

3-13-72	
REVISIONS	
DATE	CHANGE

NORTH DAKOTA
STATE HIGHWAY DEPARTMENT
Submitted: *Ed Johnson*
Design Engineer
Recommended: *Ed Johnson*
Asst Chief Engineer, Pre-Const.
Approved: *Ed Johnson*
Chief Engineer

CONSTRUCTION SIGN AND BARRICADE LOCATION DETAILS

F.H.W.A. REGION	STATE	FED. AID PROJ. NO.	SHEET
8	N.D.		40

D-754-710

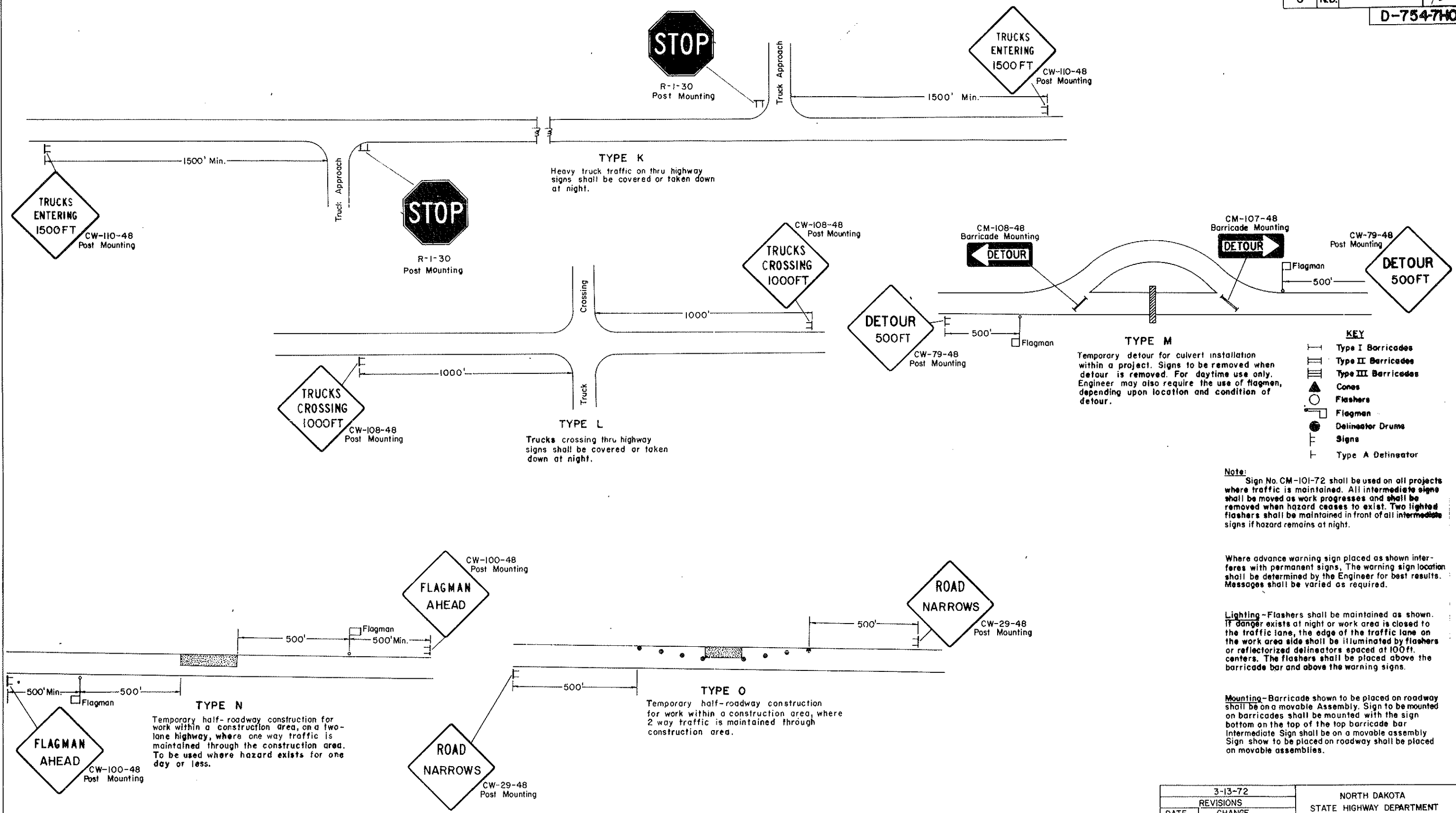

- KEY**
- Type I Barricades
 - Type II Barricades
 - Type III Barricades
 - ▲ Cones
 - Flashers
 - Flagman
 - Delineator Drums
 - Signs
 - Type A Delineator

Note:
Sign No. CM-101-72 shall be used on all projects where traffic is maintained. All intermediate signs shall be moved as work progresses and shall be removed when hazard ceases to exist. Two lighted flashers shall be maintained in front of all intermediate signs if hazard remains at night.

Where advance warning sign placed as shown interferes with permanent signs, The warning sign location shall be determined by the Engineer for best results. Messages shall be varied as required.

Lighting—Flashers shall be maintained as shown. If danger exists at night or work area is closed to the traffic lane, the edge of the traffic lane on the work area side shall be illuminated by flashers or reflectorized delineators spaced at 100 ft. centers. The flashers shall be placed above the barricade bar and above the warning signs.

Mounting—Barricade shown to be placed on roadway shall be on a movable Assembly. Sign to be mounted on barricades shall be mounted with the sign bottom on the top of the top barricade bar. Intermediate Sign shall be on a movable assembly. Sign show to be placed on roadway shall be placed on movable assemblies.

NOTE
FLAGS: All advance warning signs shall have two orange warning flags 24" square mounted perpendicular to the edges of the diamond sign and at such a distance above the edges so that when flag is hung limp it will not touch the sign.

3-13-72		NORTH DAKOTA STATE HIGHWAY DEPARTMENT
REVISIONS		
DATE	CHANGE	Submitted: <i>R. Johnson</i> Design Engineer
		Recommended: Asst. Chief Engineer, Pre-Constr.
		Approved: <i>R. Johnson</i> Chief Engineer