

INSTALL PERF. PVC PIPE
 1+00-37' Lt. to 2+25-37' Lt. 6" x 30'
 1+20-37' Rt. to 3+05-37' Rt. 6" x 35'
 2+25-37' Lt. to 3+05-37' Rt. 3" x 15.4'
 2+25-37' Lt. to 4+20-37' Lt. 6" x 19.2'
 3+05-37' Rt. to 4+20-37' Lt. 6" x 31.7'
 4+20-37' Lt. to 7+50-37' Lt. 6" x 33.7'

REMOVAL OF INLETS
 3+05-37' Rt. 1-48" x 1-48"
 4+20-37' Lt. 1-48" x 5.95'

INSTALL MANHOLE PIECES
 3+05-37' Rt. 1-48" x 1-48"
 4+20-37' Lt. 1-48" x 5.95'

INSTALL MANHOLES
 3+05-37' Rt. 1-48"
 4+20-37' Lt. 1-48"

ROADWAY OBLITERATION
 34+15 to 38+50 (U.S. 10) 500 LF

REMOVAL OF CONCRETE PAVEMENT
 (U.S. 10) Rt. 568 S.Y.
 6+00 to 9+93.2 874 S.Y.

REMOVAL OF CURB & GUTTER
 * 0+58.5 Rt. (U.S. 10) 283 LF
 0+58.5-139.9 Rt. to 67' Lt. 207 LF

INSTALL CURB & BUTTER
 Intersection Island 12' 12.0 LF
 Radius Lt. 22' 89.9 LF
 0+83 to 0+96.2 Lt. 13' 30.2 LF
 Radius Rt. 22' 127.5 LF
 Taper Rt. to 1+72.4 22' 24.1 LF
 1+72.2 to 2+12.8 Rt. 22' 72.4 LF
 9+07.2 to 9+93.2 Lt. 22' 36.0 LF
 9+15.8 to 9+93.2 Rt. 22' 77.4 LF
 0+58 to 8+99.7 Med. 42' 168.0 LF
 9+11.7 to 9+75.7 Ved. 42' 126.1 LF
 32+58.13 to 36+31.94 (U.S. 10) 292 LF

INSTALL SODDING
 0+58.5 to 2+93.2 Lt. 292 S.Y. (See Cross-Sections)

FEED ROAD DIST. NO.	DATE	FEED NO.	SHEET NO.
6	N.D.	15	13

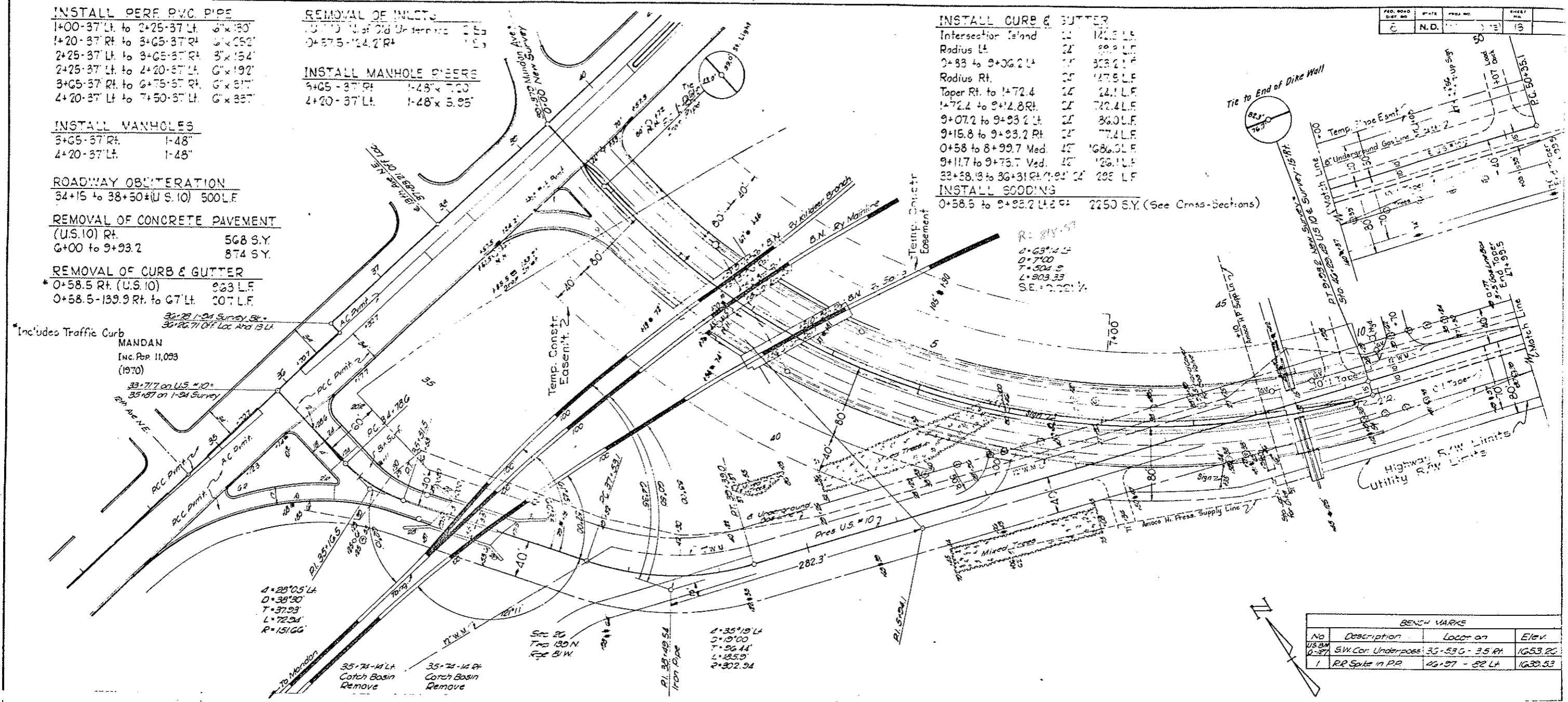

* Includes Traffic Curb
MANDAN
 Inc. Pbr. 11,093 (1970)
 33+71.7 on U.S. #10
 35+57 on 1-24 Survey
 30+28 1-24 Survey
 30+26.71 Off. Loc. And 13 Lt.

BENCH MARKS

No.	Description	Location	Elev.
US 9M 0-27	SW Corner Underpass	36+53.6 - 3.5 Rt.	1653.22
1	RR Spike in RR	46+97 - 82 Lt.	1630.53

