

CONSTRUCTION SIGNING

LEGEND

- Delineator Drums
- ← Direction of Traffic Flow
- Sign
- Flasher
- ≡ Type III Barricade
- ▨ Work Area

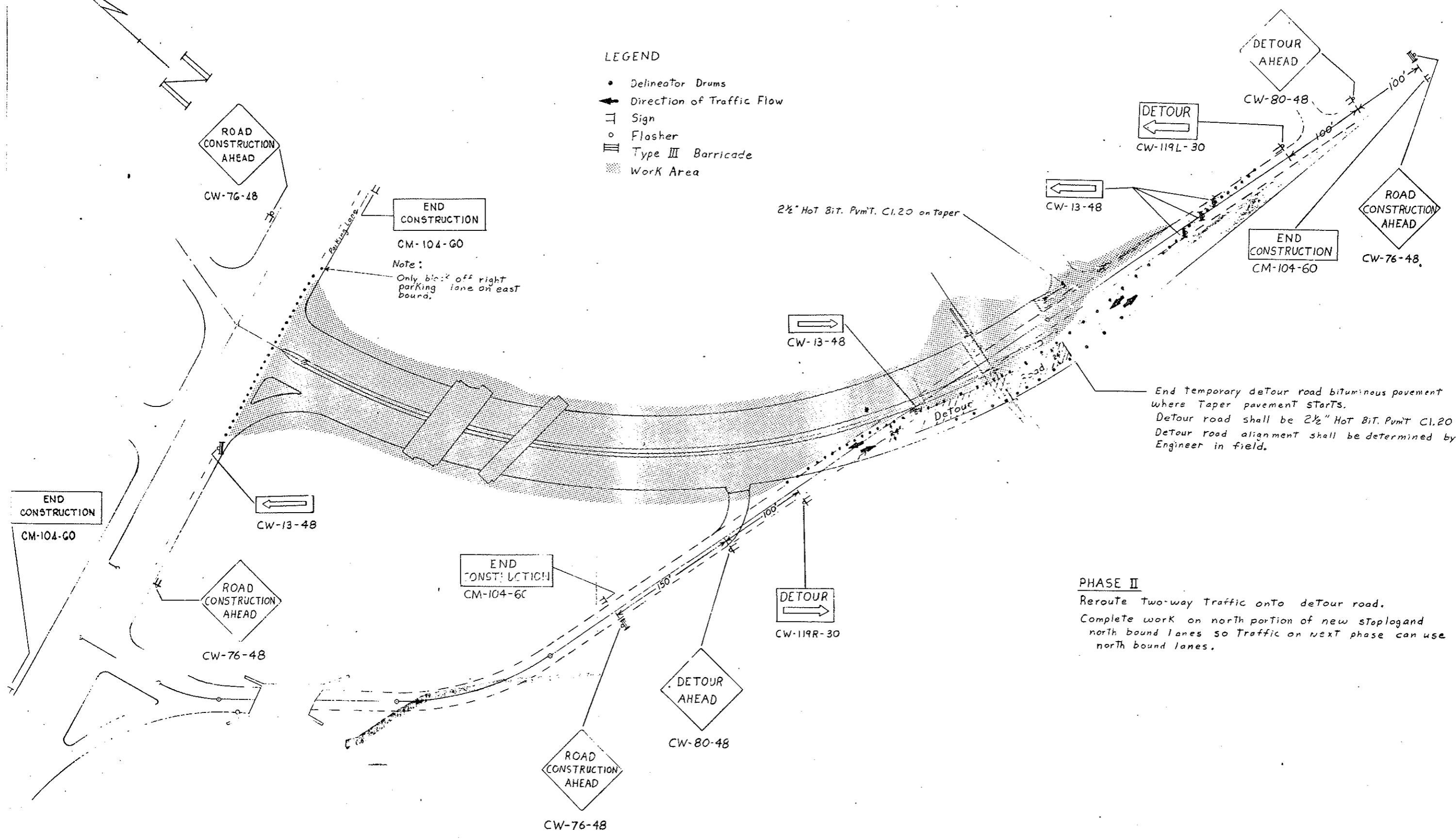

END CONSTRUCTION
CM-104-60
Note:
Only block off right parking lane on east bound.

2 1/2" Hot Bit. Pvm't. C1.20 on Taper

End temporary detour road bituminous pavement where Taper pavement starts.
Detour road shall be 2 1/2" Hot Bit. Pvm't C1.20
Detour road alignment shall be determined by Engineer in field.

PHASE II

Reroute two-way traffic onto detour road.
Complete work on north portion of new stoplog and north bound lanes so traffic on next phase can use north bound lanes.