

CITY OF MANDAN, N. D.

•CORPORATE LIMITS•

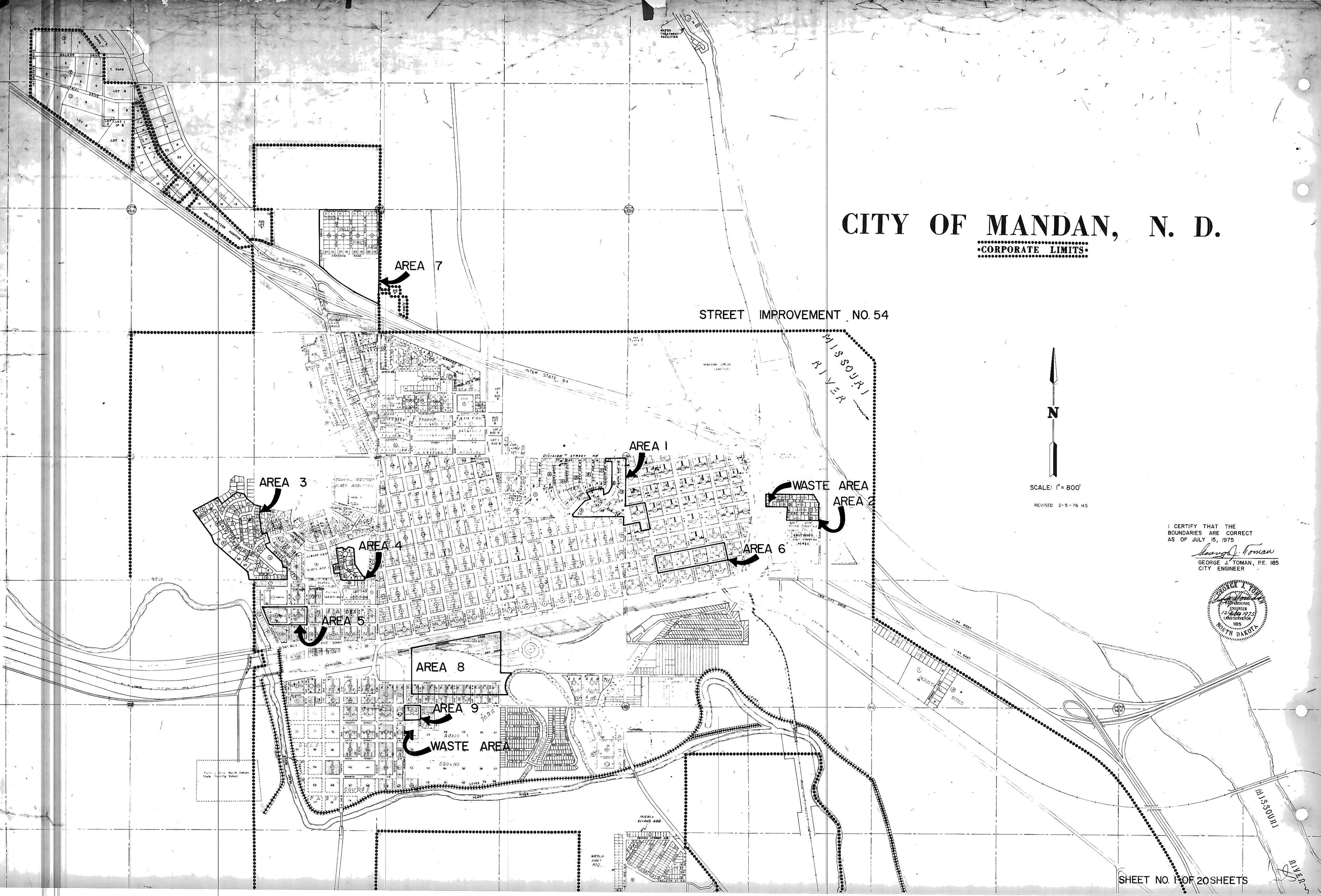

SCALE: 1" = 800'

REVISED 2-5-76 HS

I CERTIFY THAT THE BOUNDARIES ARE CORRECT AS OF JULY 15, 1975

George J. Toman
GEORGE J. TOMAN, P.E. 185
CITY ENGINEER

