

SUNSET DRIVE

Note: Street Width Shown is back to back of Curb

Note: Place expansion Joints in Curb and Gutter ON SUNSET as Follows:

- | | |
|-----------|-----------|
| East Side | West Side |
| 0+33 | 0+33 |
| 1+46 | 1+40 |
| 3+06 | 2+80 |
| 4+66 | 3+40 |
| 6+26 | 4+50 |
| 7+86 | 5+80 |
| 8+95 | 6+40 |
| | 7+30 |

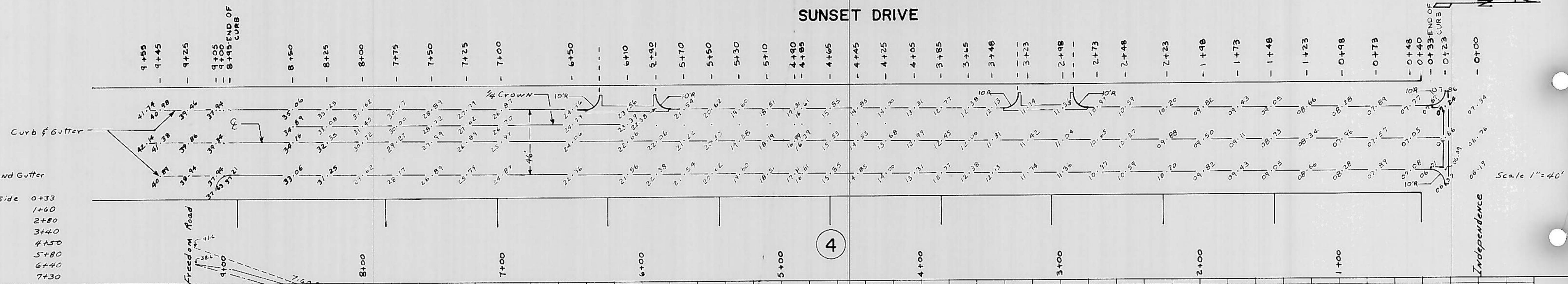

Scale 1"=40'

Independence

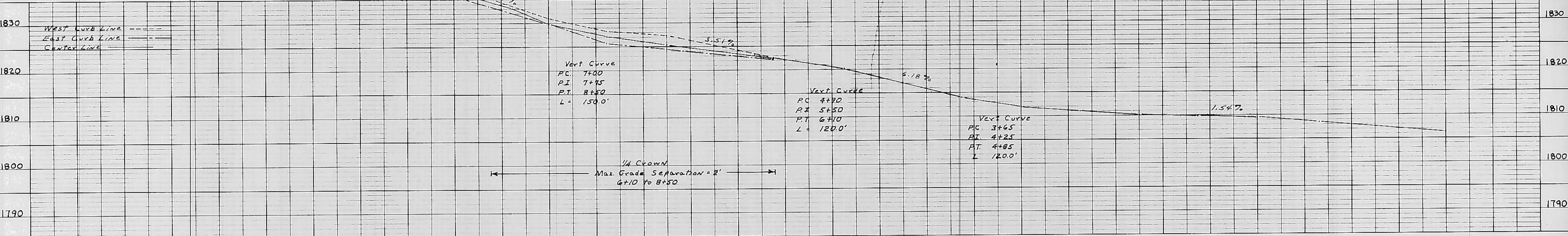

CONCORD

Note: Place expansion Joints in Curb and gutter on both sides of Concord, Lexington and Valley Forge at Stations:

- 0+33
- 1+46
- 3+06
- 4+66
- 6+26
- 7+86
- 8+95

Note: Place 3 1/2" thick Asphalt Concrete base ON Terra Valle, Independence and Sunset Streets, 2 1/2" thick Asphalt Concrete base ON Concord, Lexington, Valley Forge and Freedom Road.

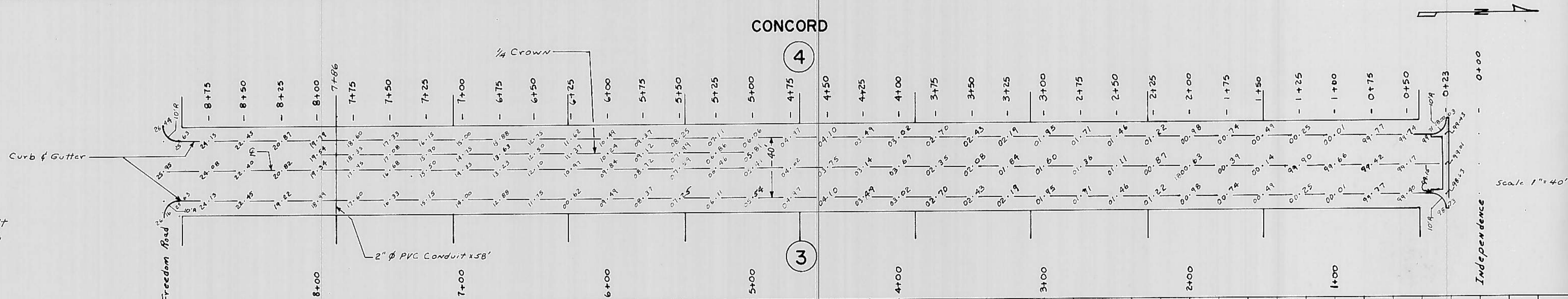

Scale 1"=40'

Independence

