

DATE	
BY	
REVISIONS	
NOTE BOOK	
ALIGNMENT CHECKED	
1ST. OF WAY CHECKED	
No.	

DATE	
BY	
REVISIONS	
NOTE BOOK	
GRADES CHECKED	
1ST. OF WAY CHECKED	
NO. OF REVISIONS CHECKED	
No.	

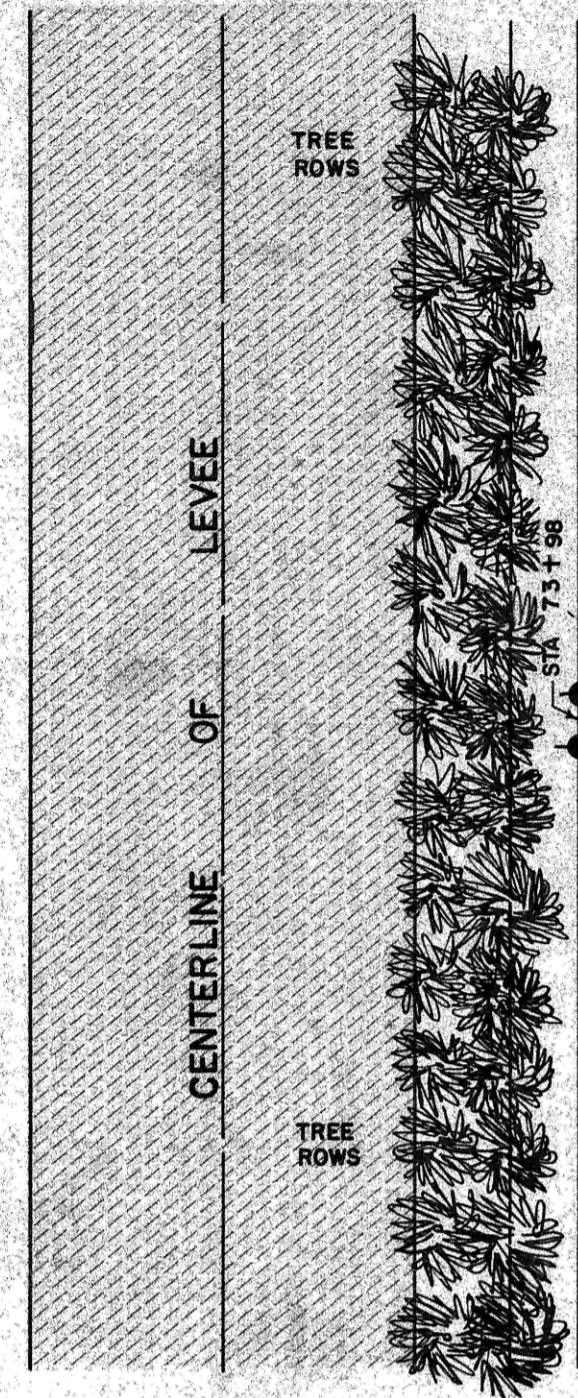

OPEN AREA

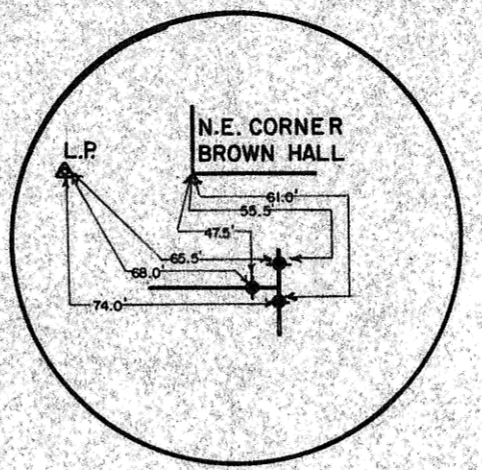
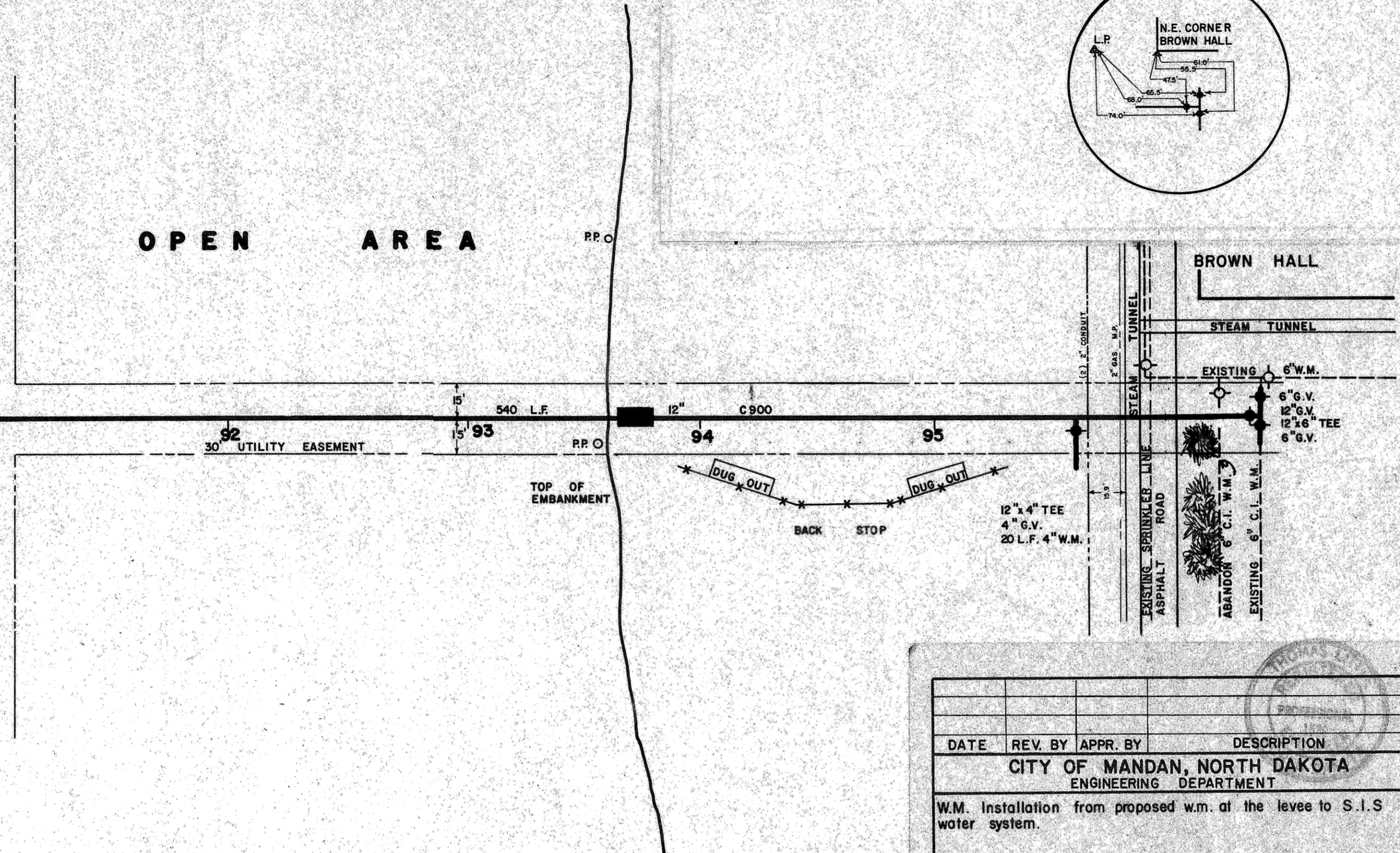

DATE	REV. BY	APPR. BY	DESCRIPTION
CITY OF MANDAN, NORTH DAKOTA ENGINEERING DEPARTMENT			
W.M. Installation from proposed w.m. at the levee to S.I.S water system.			
CITY ENGR.	TOM LITTLE	DRAWN BY	BILL BEMENT
APPROVED	BY	CHECKED	DATE: MAY 1985
PROJECT NO.	85-2	DISTRICT NO.	9
		SHEET	8 OF 10

N  
 ↓  
 HORZ = 1" = 40'  
 VERT 1" = 2'

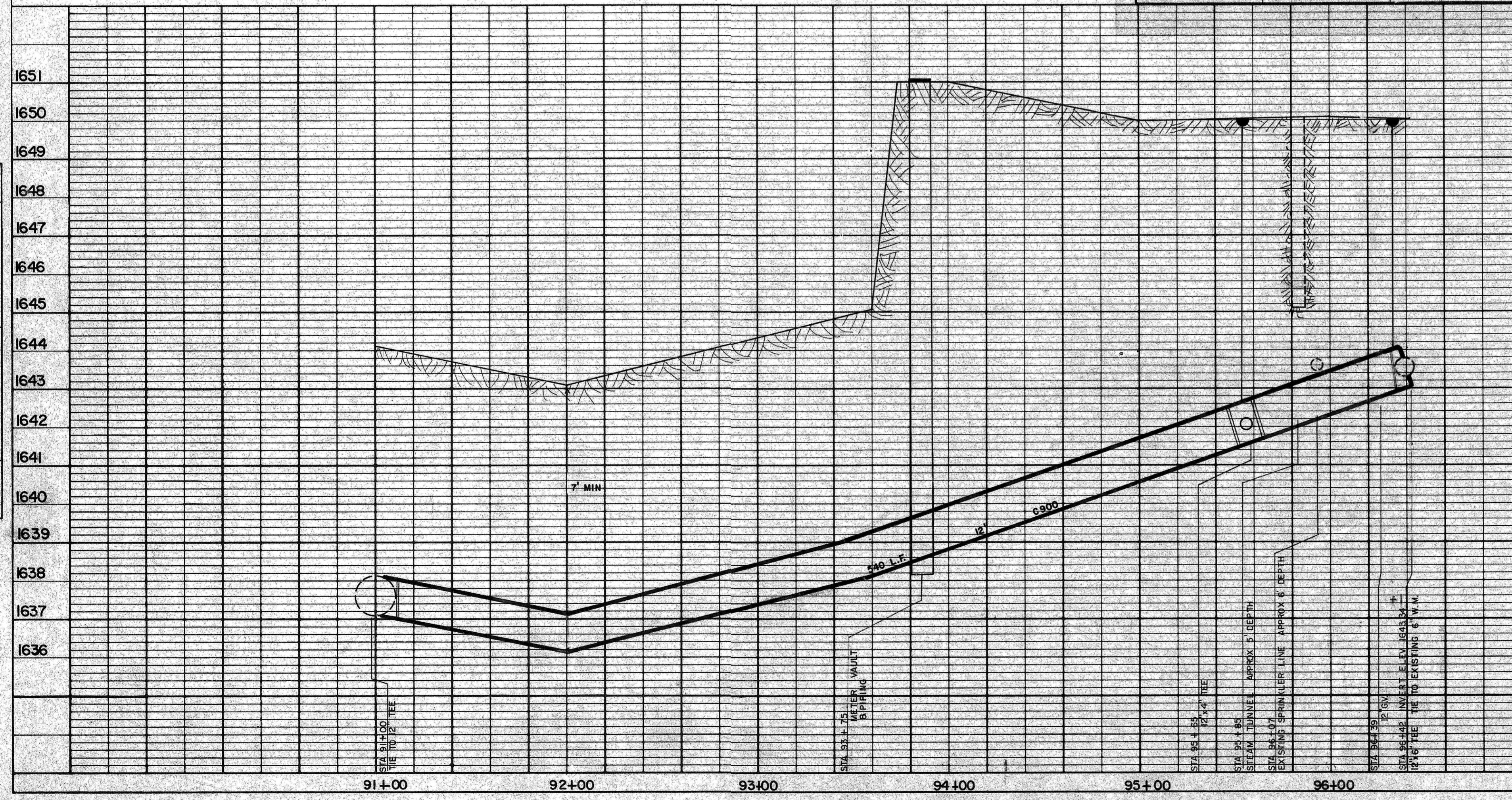

AS BUILT