

1.4
8.75
3.91

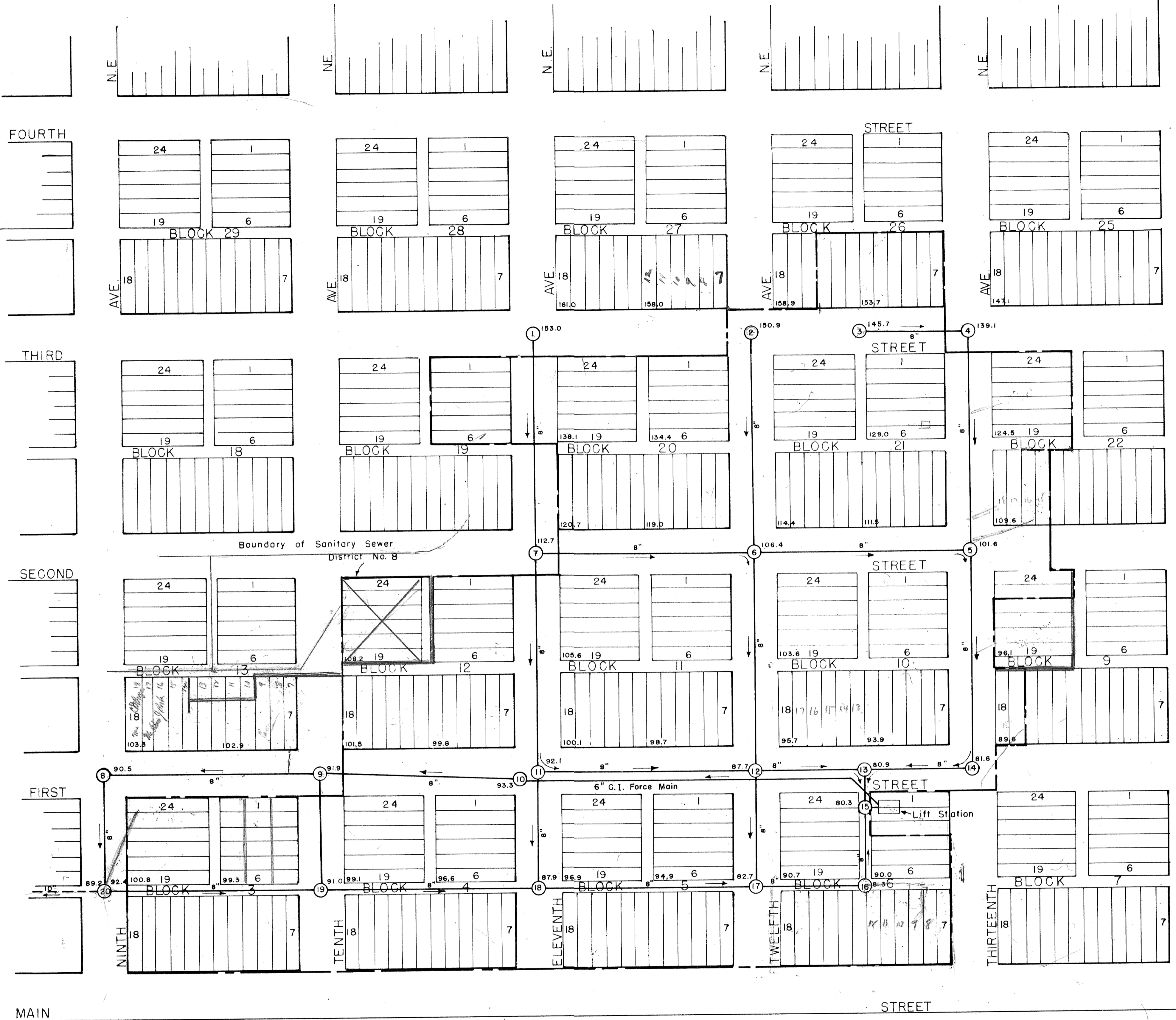

9
48
10
2
72
72
21
236 lots 25X 140

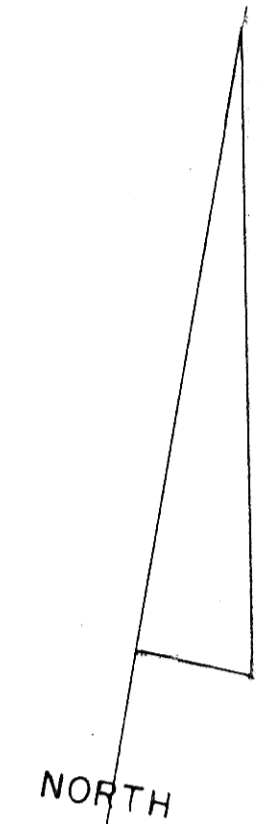

NOTE: Assumed elevations are from invert of existing manhole. Elevation of this manhole taken from old plans to be 89.2

MANDAN, NORTH DAKOTA
SANITARY SEWER
DISTRICT NO. 8



SHEET NO. 1
Drawn by RVT Checked by JTL
SCALE 1" = 100'
George J. Toman Consulting Eng.
Mandan, N. D.