

- NOTES:**
- CONTRACTOR SHALL REPAIR ANY EXISTING WATER, SEWER, GAS, POWER, CABLE TV, STREET LIGHT WIRING, TELEPHONE, OR OTHER UTILITY THAT IS DISTURBED DURING CONSTRUCTION TO THE SATISFACTION OF THE OWNER.
  - UTILITY LOCATIONS ARE NOT GUARANTEED DUE TO LACK OF RECORDS.
  - ALL DISTURBED LAWNS ARE TO BE RESODDED (575 S.Y.) 1282 S.Y.
  - REMOVE & SALVAGE EXISTING MANHOLES & CASTINGS AT THE FOLLOWING LOCATIONS. COSTS ARE TO BE INCIDENTAL TO PROJECT.  
- (0+06) 5' LT.  
0+00  
0+76  
3+23  
3+99  
584' 22.45'
  - REMOVE & REPLACE ASPHALT PAVEMENT STA. 1+70 TO 2+34 16' x 17' = 135 S.Y. 1457 S.Y. STA. 3+73 TO 4+31 (56' x 14' = 99 S.Y.) (54.45' x 28.9') = 1385 S.Y.
  - REMOVE & REPLACE SIDEWALK 6" STA. 1+65 TO 2+38 (100 S.F.) 2699 S.F. STA. 3+69 TO 4+35 (80 S.F.) 184 S.F.
  - INSTALL 60+5 LF 8" P.V.C. 505.5492 LF 24" P.V.C. 4 TYPE "A" MH - 2 EA. (PAY QUANT. 3 EA) TYPE "B" MH - 3 EA. 2 REMOVED BY OTHERS
  - REMOVE & REPLACE TREES & SHRUBS STA. 4+56, 3 RT. ARBORVITAE - 3 STA. 4+58, 7 RT. ARBORVITAE - 1 STA. 4+60, 11 RT. ARBORVITAE - 3
  - CLEARING & GRUBBING STA. 2+59, 10 RT.
  - REMOVE & REPLACE ALL FENCES REQUIRED TO COMPLETE THE WORK. (INCIDENTAL TO PROJECT.)
  - 6" WATERMAIN LOWERING STA. 5+45
  - REMOVE EX. 24" V.C.P. FROM STA. 0+00 TO STA. 5+00 (FILLED W/CRETE)
  - ALL MOBILE HOME & SHEDS WITHIN THE CONSTRUCTION AREA SHALL BE REMOVED BY OTHERS.

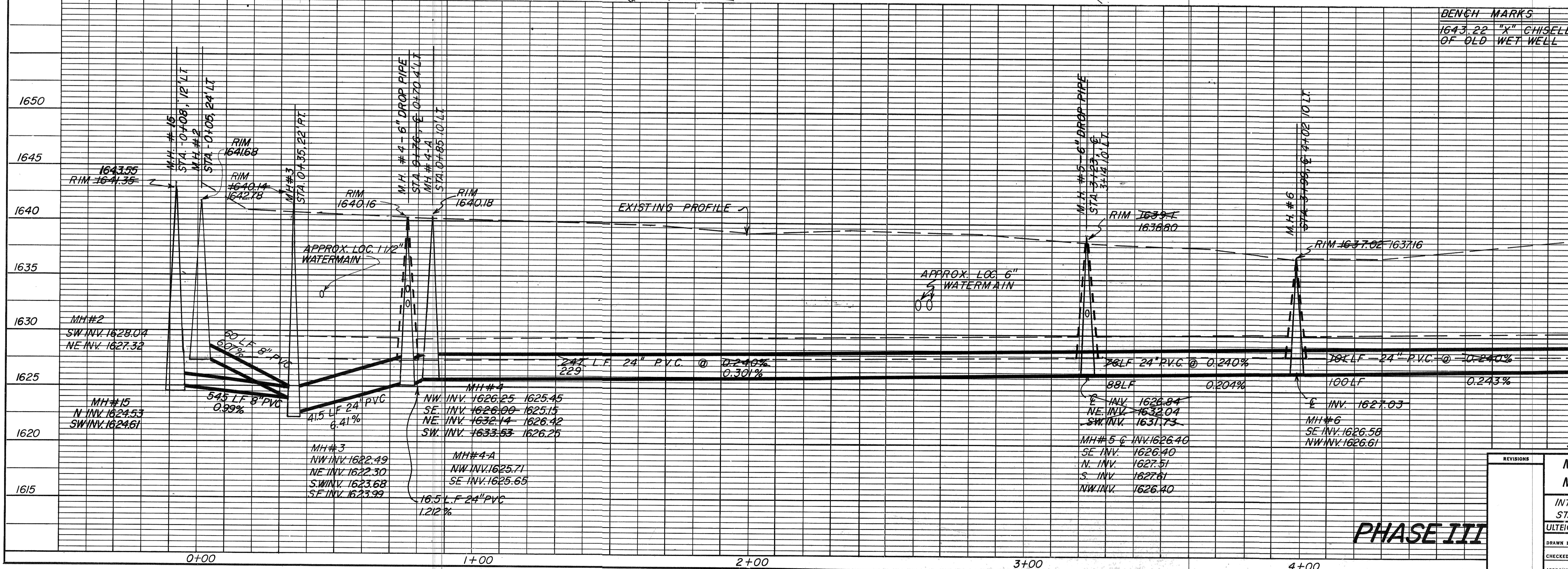

**REVISIONS**

**MANDAN INTERCEPTOR 1984**  
**MANDAN, NORTH DAKOTA**

**INTERCEPTOR REPLACEMENT**  
STA. 0+00 TO STA. 5+00

ULTEIG ENGINEERS INC. BISMARCK - FARGO - MINNEAPOLIS

SCALE: AS SHOWN  
DRAWING NO.: 4241  
DATE: MAY 1984  
SHEET: P-1 OF

APPROVED BY: *RL*

**PHASE III**