

- NOTE:**  
 1. CONTRACTOR SHALL REPAIR ANY EXISTING WATER, SEWER, GAS, POWER, CABLE TV, STREET LIGHT WIRING, TELEPHONE, OR OTHER UTILITY THAT IS DISTURBED DURING CONSTRUCTION TO THE SATISFACTION OF THE OWNER.  
 2. UTILITY LOCATIONS ARE NOT GUARANTEED DUE TO LACK OF RECORDS.  
 3. ALL DISTURBED LAWNS ARE TO BE RESODDED (250-51), 1344 SY  
 4. REMOVE & SALVAGE EXISTING MANHOLES & CASTINGS AT THE FOLLOWING LOCATIONS. COSTS ARE TO BE INCIDENTAL TO PROJECT.  
 5+07  
 5+39.5  
 6+31.5  
 8+00  
 5. REMOVE & REPLACE ASPHALT PAVEMENT STA. 7+95 TO 8+38. (143.13 - 62 SY) 2365x575=1511 S.F.  
 6. REMOVE & REPLACE SIDEWALK STA. 7+92 TO 8+40. 170-5-16 (136 S.F. N. SIDE) 6 (127.35x25)=318.4 SF  
 7. INSTALL 500 LF - 24\"/>

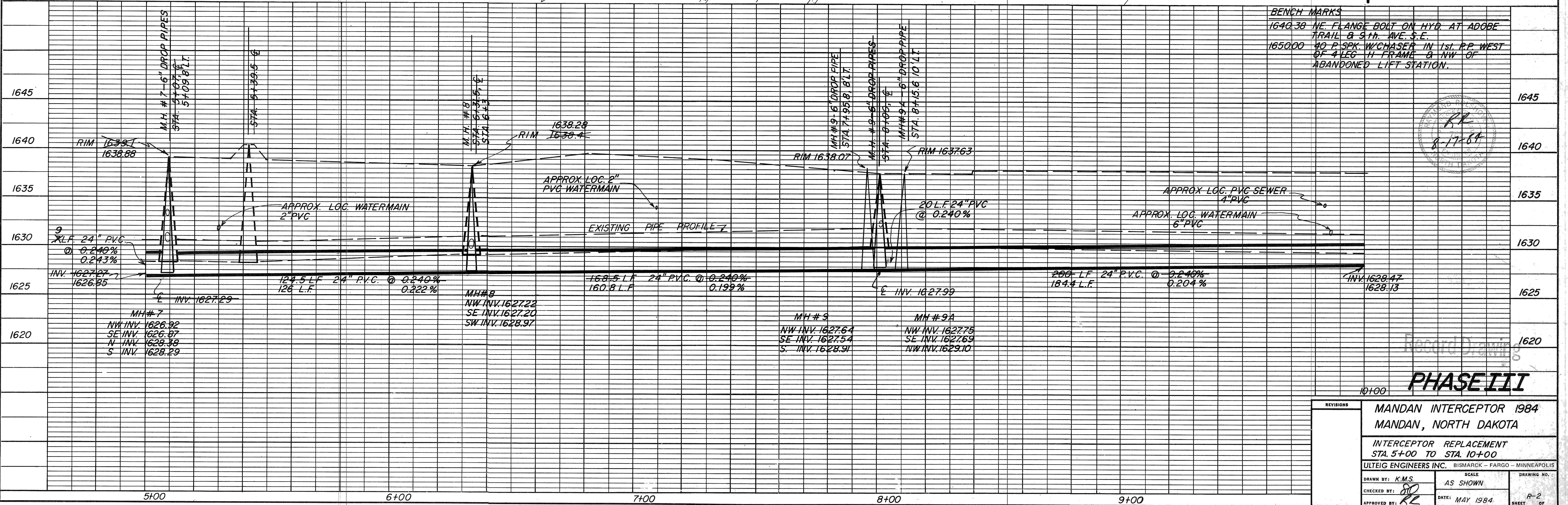

**BENCH MARKS**  
 1640.38 NE FLANGE BOLT ON HYD. AT ADOBE TRAIL & 5TH AVE. S.E.  
 1650.00 40 P. 3PK. W/CHASER IN 1ST. RP. WEST OF 4 LEG. II FRAME & NW OF ABANDONED LIFT STATION.

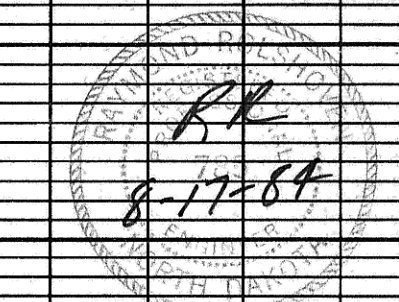

**PHASE III**

REVISIONS MANDAN INTERCEPTOR 1984 MANDAN, NORTH DAKOTA		
INTERCEPTOR REPLACEMENT STA. 5+00 TO STA. 10+00		
ULTEIG ENGINEERS INC. BISMARCK - FARGO - MINNEAPOLIS		
DRAWN BY: K.M.S. CHECKED BY: [Signature] APPROVED BY: [Signature]	AS SHOWN DATE: MAY 1984	DRAWING NO.: R-2 SHEET OF