

CITY OF MANDAN, ND SEWER ACCT. NO. 422

(CITY PROJECT NO. 91-5)

LOCATION MAP



VICINITY MAP

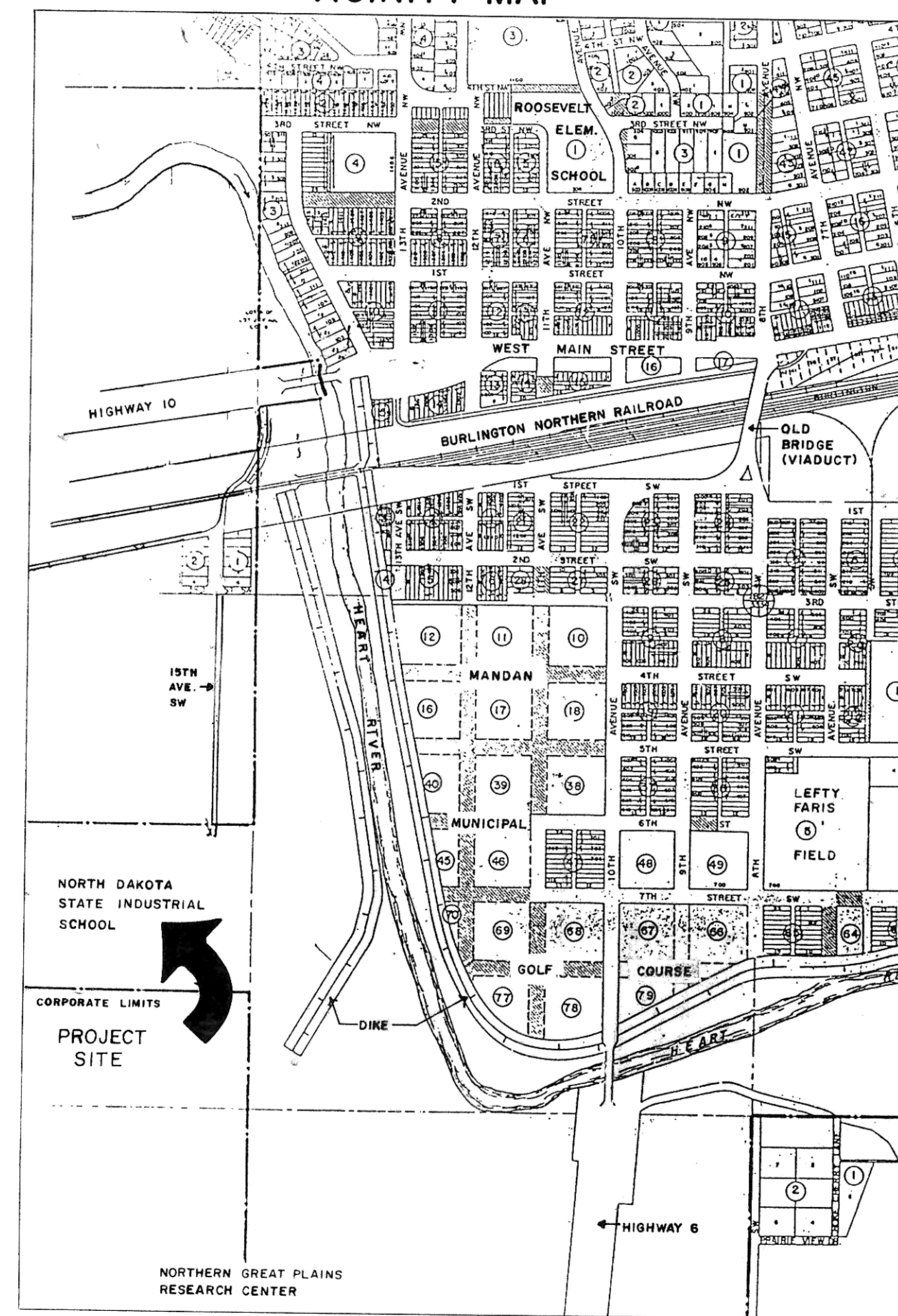

INDEX OF DRAWINGS

| SHT | TITLE |
|-----|-----------------------------------------|
| 1 | TITLE SHEET |
| 2 | MANHOLE 1 TO MANHOLE 4, PLAN & PROFILE |
| 3 | MANHOLE 4 TO MANHOLE 6, PLAN & PROFILE |
| 4 | MANHOLE 6 TO MANHOLE 10, PLAN & PROFILE |
| 5 | FORCEMAIN, PLAN & PROFILE |
| 6 | DETAIL SHEET |
| 7 | DETAIL SHEET-LIFT STATION |

LEGEND

- SEWERMAIN (TO BE INSTALLED)
- OVERHEAD POWER
- POWER POLE
- FENCE (BARBED-WIRE)
- PVC SOLID PIPE
- UNDERGROUND POWER
- GAS LINE
- CONCRETE
- GRAVEL/DIRT ROAD
- WOODLAND
- RIPRAP
- ASPHALT
- LIFT STATION
- EXISTING CLAY SEWERMAIN
- IRRIGATION PIPE
- IRRIGATION PUMP
- EXISTING FORCEMAIN
- FORCEMAIN (TO BE INSTALLED)

BOARD OF CITY COMMISSIONERS
MANDAN, NORTH DAKOTA

ROBERT DYKSHOORN, PRESIDENT
ED FROEHLICH, COMMISSIONER
TOM KELSCH, COMMISSIONER
TONY ENGELHARDT, COMMISSIONER
BOB CHRISTIANSON, COMMISSIONER
KEVIN CHRIST, AUDITOR
THOMAS LITTLE, CITY ENGINEER



APPROVED: _____ DATE _____
THOMAS LITTLE, R.P.E. CITY ENGINEER, MANDAN, NORTH DAKOTA

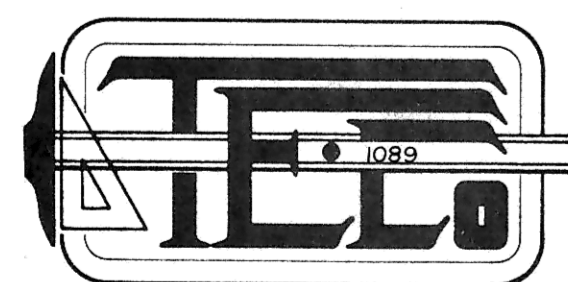

PREPARED BY:

TOMAN ENGINEERING CO. ★ CONSULTING ENGINEERS ★

CONSULTING CIVIL & ENVIRONMENTAL ENGINEERS
P.O. BOX 708 • 906 2ND ST. N.W. • MANDAN, NORTH DAKOTA 58554 • 701-663-6483

MANDAN, NORTH DAKOTA

JULY 1991

MANDAN, NORTH DAKOTA

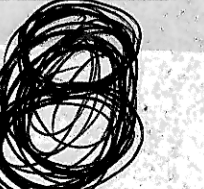

P 91-5
A 422